



Castles

OFFERS IN EXCESS OF

£184,950

1a Charlton Road

London, N9 8UL

PROPERTY SUMMARY

Castles are delighted to present this one bedroom/studio flat with a separate bedroom. The property is situated on the Bird Development N9. This property has features to include, separate sleeping area, open plan kitchen/lounge, bathroom, loft space and long lease of 152 years remaining. Internal viewings highly recommended.







APPROXIMATE GROSS INTERNAL AREA
31.72 sqm / 341.43 sqft

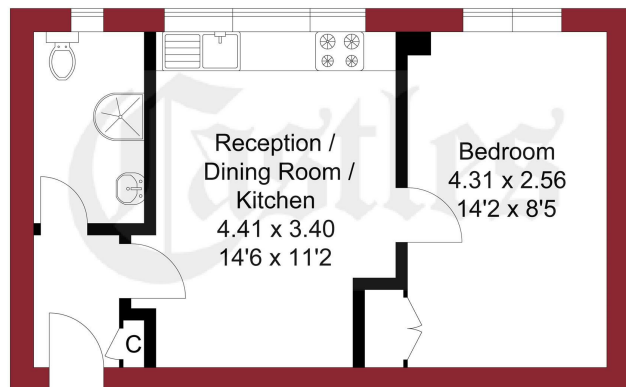

SECOND FLOOR

THIS PLAN IS FOR ILLUSTRATION ONLY AND MAY NOT BE
REPRESENTATIVE OF THE PROPERTY

For a guide to the area
please scan this code for
more information

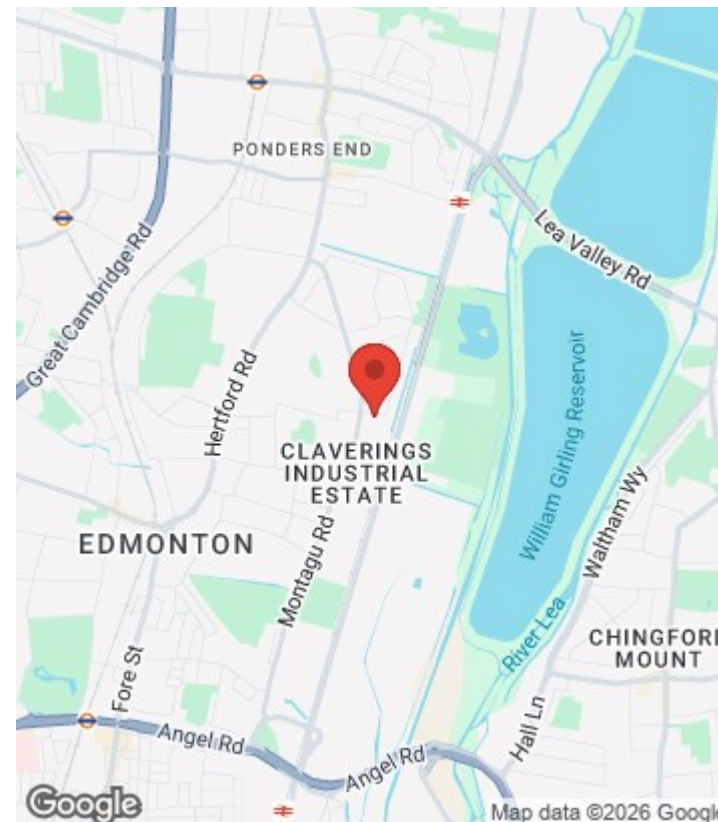
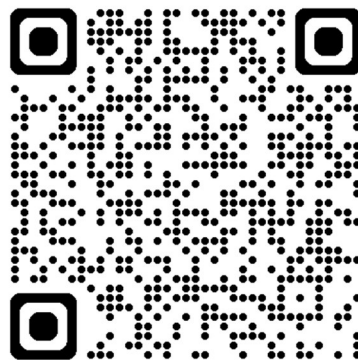

Flat - Second Floor

Leasehold

Council:

Council Tax Band: B

Agents Note: Whilst every care has been taken to prepare these particulars, they are for guidance purposes only. All measurements are approximate and are for general guidance purposes only and whilst every care has been taken to ensure their accuracy, they should not be relied upon and potential buyers/tenants are advised to recheck the measurements



OFFICE ADDRESS

438 Hertford Road
Edmonton
London
N9 8AB

OFFICE DETAILS

020 8804 8123
edmonton@castles.london
<https://www.castles.london/>

